

TECHNICAL DATA:

Nominal Flow Rate: 440 GPM / 100 cubic m/hr at 2m Head Loss
 Filter Area: 868 sq in / 5600 sq cm
 Screen Size Available: 50, 80, 100, 120, 150, 200, 400, 800 micron
 Max. Working Pressure: 150psi / 10 bar
 Min. Upstream Line Pressure Required During Rinse Cycle: 15 psi / 1 bar
 Max. Working Temperature: 150°F / 65°C
 Approximate Rinse Cycle Time: 20 Sec.
 Inlet & Outlet Connection: DN100 Table E / ISO PN10 / ANSI CL150
 Flush Drain Outlet Connection: 2" BSPT Female
 Main Drain Header: DN50 2" Nominal Bore
 Approximate Weight: Empty ----- 265 lbs / 120 kg
 Full of Water --- 441 lbs / 200 kg

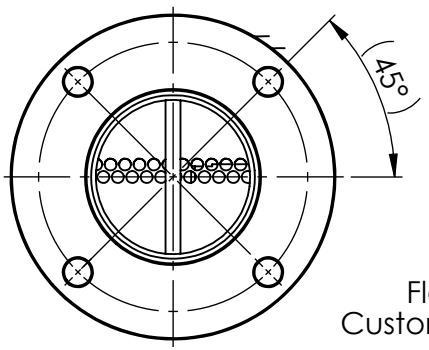

Flange Details Depend
Customer Selected Flange Type

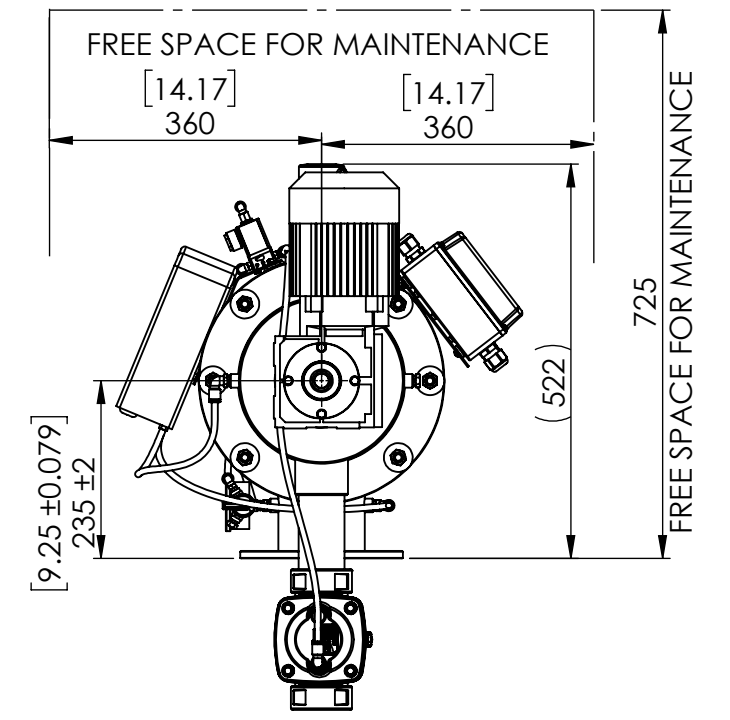
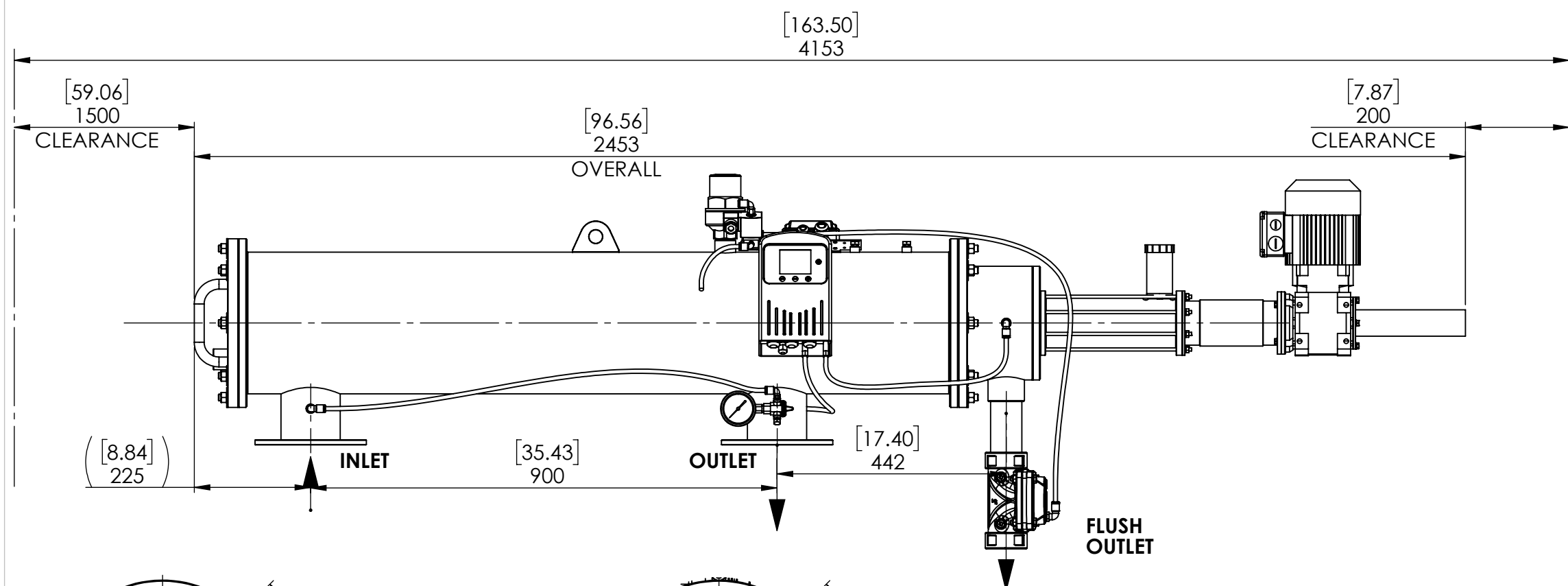
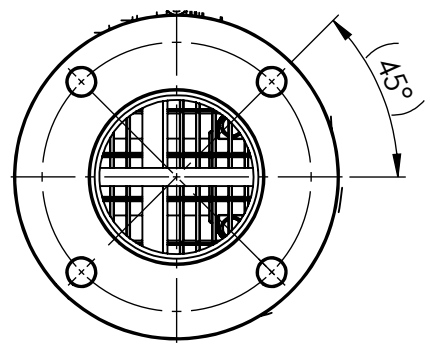

PROPRIETARY AND CONFIDENTIAL
THE INFORMATION CONTAINED IN THIS DRAWING IS THE SOLE PROPERTY OF FILTAWORX PTY. LTD. ANY REPRODUCTION IN PART OR AS A WHOLE WITHOUT THE WRITTEN PERMISSION OF FILTAWORX PTY. LTD. IS PROHIBITED.

MATERIAL
STAINLESS STEEL BODY
GLASS REINFORCED NYLON LID

TOL. MACHINING	±0.25
TOL. ANGULAR	±0.25°

FINISH

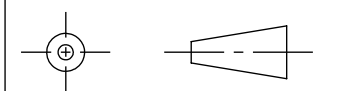

DIMENSIONS ARE IN [inches]/mm



TITLE
FED 100EX WATER FILTER
ELECTRIC DRIVE AUTO SELF CLEANING
DN100 TABLE E / ISO PN10 / ANSI CL150

SIZE A3	DWG. NO. GA-04556	REV. 0
------------	----------------------	-----------

SCALE: 1:10. WEIGHT: SEE TECHNICAL DATA SHEET: 1 OF 1